

**DATA SHEET**
**NE 1227**

**MODEL :** NE 1227  
**VOLTAGE :** 12  
**MATERIAL :** Polypropylene  
**DIMENSIONS :** Millimetres (mm)  
**NUMBER OF CYCLES :** 400~600 @ 100%DOD  
**BATTERY :** EV Battery  
**ENERGY DENSITY :** ↑10%  
**GRID CORROSION :** ↓50%  
**ACID SATISFACTION :** 0%

**12 VOLT**
**PHYSICAL SPECIFICATIONS**

MODEL	DIMENSIONS (MM/INCH)				WEIGHT (KG/LBS)	TERMINAL	CONTAINER
	L	W	H	Total Height			
TNE12-27	181/7.13	77/3.03	170/6.69	175/6.89	6.80/14.99	I10	ABS UL94-HB (Optional: FR ABS UL94-V0)

**PRODUCT SPECIFICATIONS**

NOMINAL VOLTAGE	RATED CAPACITY 25°C/77°F	OPREATING TEMP.RANGE	CAPACITY EFFECTED TEMP	CAPACITY VS STORAGE TIME
12V	27Ah 20hr Rate (1.80V/cell) 25.0Ah 10hr Rate (1.75V/cell) 23.5Ah 5hr Rate (1.75V/cell) 22.3Ah 2hr Rate (1.75V/cell)	Discharge:-15°C~50°C (5°F~122°F) Charge:0°C~40°C (32°F~104°F) Storage:-15°C~40°C (5°F~104°F) Optimum:25°C±3°C (77°F±5°F)	40°C (104°F):106% 25°C (77°F):100% 0°C (32°F):90% -15°C (5°F):76%	Three months : 90% Six months : 80% Nine months : 60%

**CONSTANT CURRENT DISCHARGE (A)@25°C (77°F)**

F.V/TIME	30min	45min	1h	2h	3h	4h	5h	6h	8h	10h	20h
1.85V/cell	30.4	21.7	17.2	10.1	6.95	5.25	4.25	3.67	2.90	2.39	1.31
1.80V/cell	31.4	22.3	17.7	10.5	7.10	5.42	4.42	3.81	2.98	2.45	1.35
1.75V/cell	32.3	23.2	18.4	11.2	7.49	5.67	4.70	4.00	3.07	2.50	1.38
1.70V/cell	33.2	23.8	19.0	11.3	7.64	5.81	4.74	4.08	3.14	2.57	1.41
1.68V/cell	33.9	24.6	19.7	11.5	7.75	5.95	4.88	4.16	3.21	2.61	1.42
1.60V/cell	34.8	25.2	20.1	11.8	8.02	6.12	4.95	4.27	3.29	2.70	1.43

**CONSTANT POWER DISCHARGE (W/cell)@25°C (77°F)**

F.V/TIME	30min	45min	1h	2h	3h	4h	5h	6h	8h	10h	20h
1.85V/cell	59.4	42.7	34.0	20.2	13.9	10.6	8.58	7.42	5.87	4.85	2.66
1.80V/cell	61.1	43.7	34.9	20.8	14.2	10.9	8.88	7.67	6.01	4.96	2.74
1.75V/cell	62.7	45.3	36.1	22.1	14.9	11.3	9.40	8.01	6.16	5.04	2.78
1.70V/cell	63.9	46.1	37.1	22.3	15.1	11.5	9.43	8.12	6.28	5.14	2.83
1.68V/cell	64.8	47.3	38.2	22.4	15.2	11.7	9.64	8.24	6.36	5.19	2.84
1.60V/cell	66.0	48.2	38.6	23.0	15.6	12.0	9.70	8.38	6.48	5.32	2.85



BATTERY DIMENSIONS (mm)

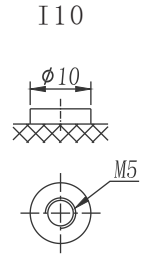
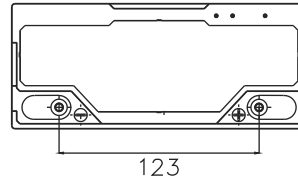
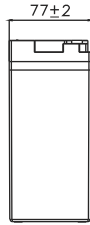
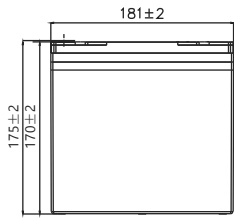

ELECTRICAL CHARACTERISTICS

Discharging Characteristics@25°C(77°F)

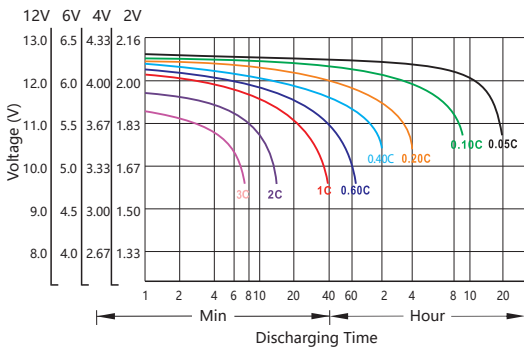

Charging Characteristics@25°C(77°F)

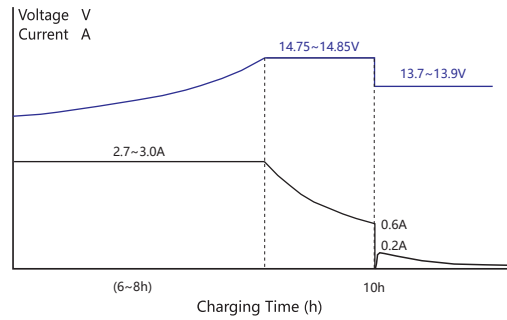

Capacity vs Temperature

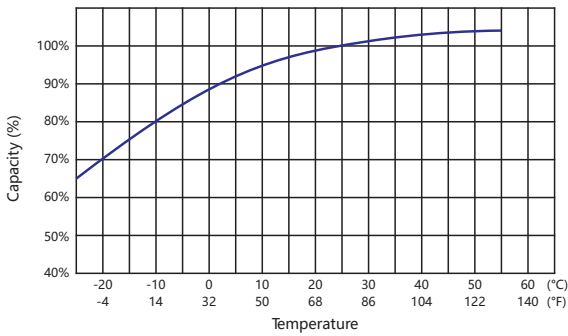

Self-discharge vs Time

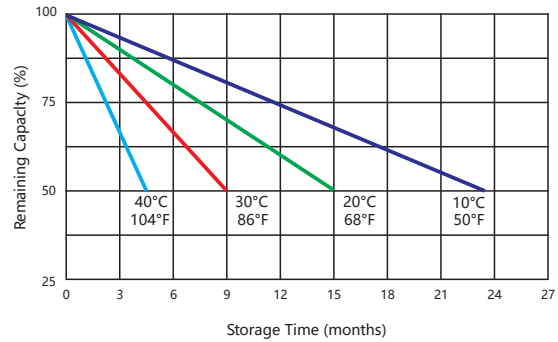

Cycle Life vs Depth of Discharge@25°C(77°F)

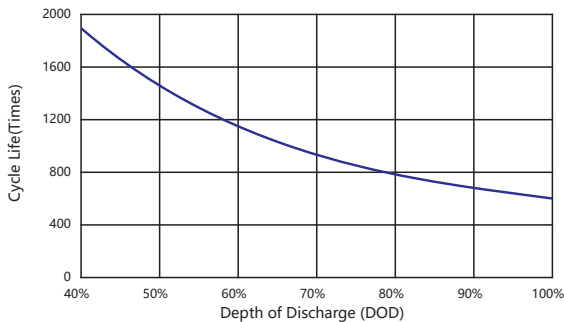

Cycle Life vs Remaining Capacity@25°C(77°F)

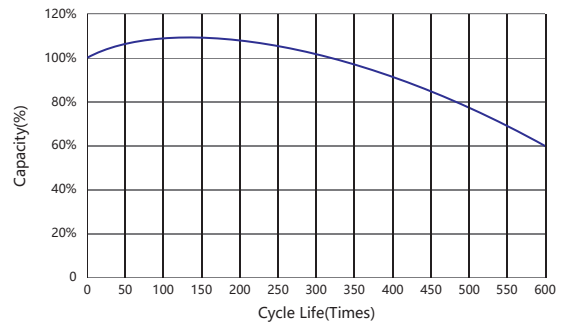



**USAGE AND MAINTENANCE**

LIMITED CURRENT	LIMITED VOLTAGE	FLEATING VOLTAGE
Limited current: $\leq 0.2C_7A$	14.75V~14.85V@25°C(77°F) Temp.Coefficient:- 24mV/°C	13.7V~13.9V@25°C(77°F) Temp.Coefficient:- 18mV/°C

**PRODUCT APPLICATIONS**



Electric Motorcycle



Electric Tricycle



Wheelchair



E-scooter



Sweeper



Kid's Electric Bike



**NEURON ENERGY**

**OFFICE :** 505, SAI HERITAGE, TILAK ROAD, GHATKOPAR (E), MUMBAI - 400 077

**BRANCH :** DELHI | MUMBAI | CHENNAI | VARANASI | KOLKATA

**TOLL FREE NUMBER :** 1800-102-2139 | **EMAIL :** INFO@NEURONENERGY.IN

*Neuron Energy is not liable for damages that may result from any information provided in or omitted from his publication, under any circumstances. Neuron Energy reserves the right to make adjustments to this publication at any time, without notice or obligation.*